

MOTHELCARE PREPARATORY SCHOOLS

TOP CLASS ASSESSMENT WORK TERM II 2020 - SET 2



ENGLISH (LANGUAGE DEVELOPMENT)

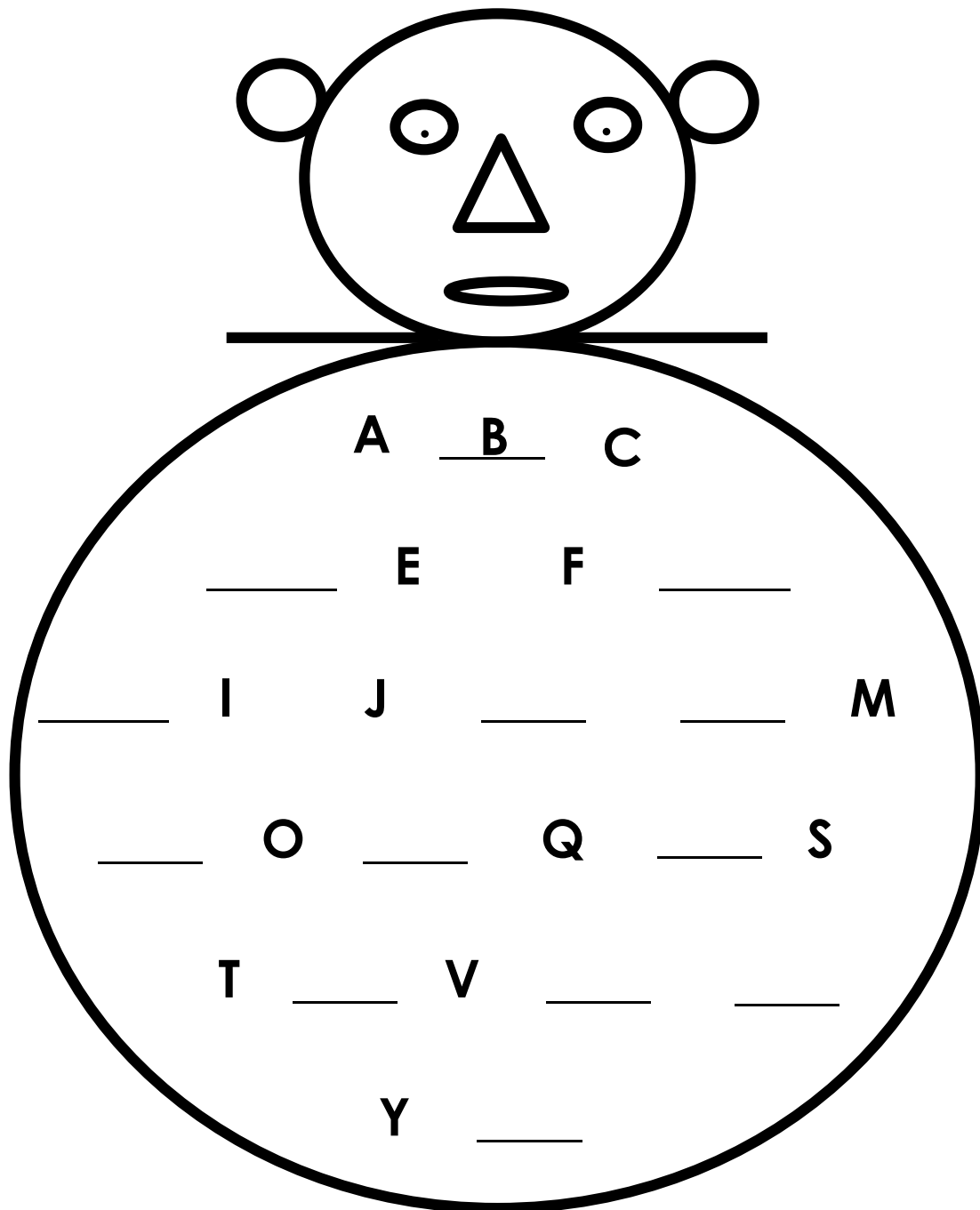

Name: _____ Stream: _____

1. Fill in the missing letters.



2. Complete the story.

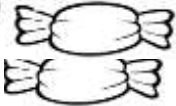

Mary is a  _____. She has a  _____.

and a  _____ in her  _____.

Mary likes to eat   _____ and

  _____. At home she plays with a

 _____ and a toy  _____.

She has three    _____ and a red

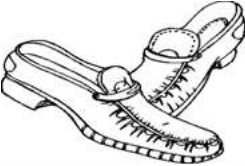
 _____ plus black  _____.

**pencil, apples, sweets, book, bag, cat, car,
shoes, dress, cups, girl**

3. Match to the belonging.

farmer

shop

nurse/doctor

school

sheikh

church

priest

garden

teacher

hospital

shopkeeper

mosque

4. Name the pictures.

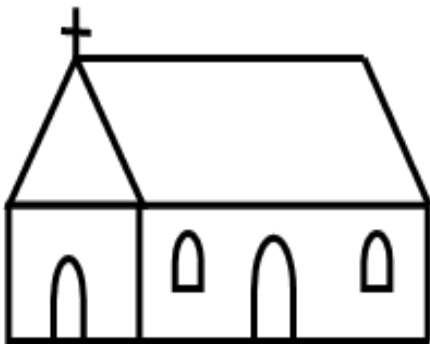

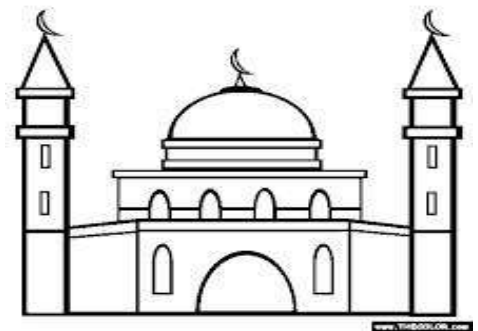

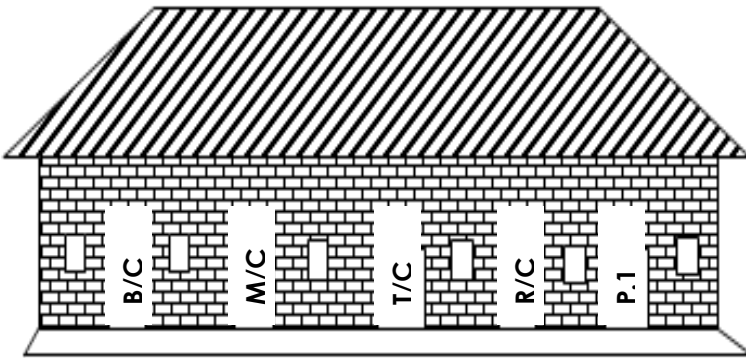
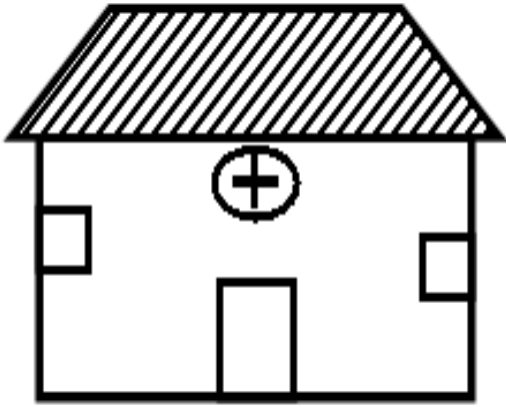

(hospital , church , school , mosque , market)

5. Fill in the right word.



The flower is _____ the pail.

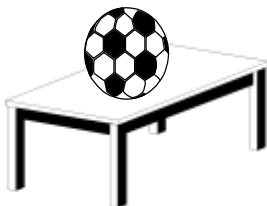

The ball is _____ the table.



The bird is flying _____ the tree.

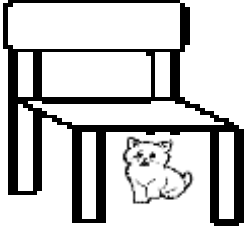

The cat is _____ the chair.

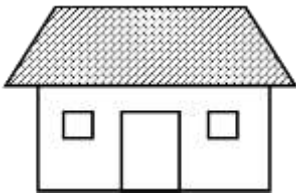

The hut is _____ the house.

(under , in , over , on , near)

ORAL

6. Why do you come to school?
7. What is the role of a nurse?
8. Mention any important place in your community.
9. I am an animal, I have long ears and a twinkling nose. Who am I?
10. I am a tall building, I have many floors. Who am I?

-The end-